

TITAN SELF SUPPORTING TOWERS

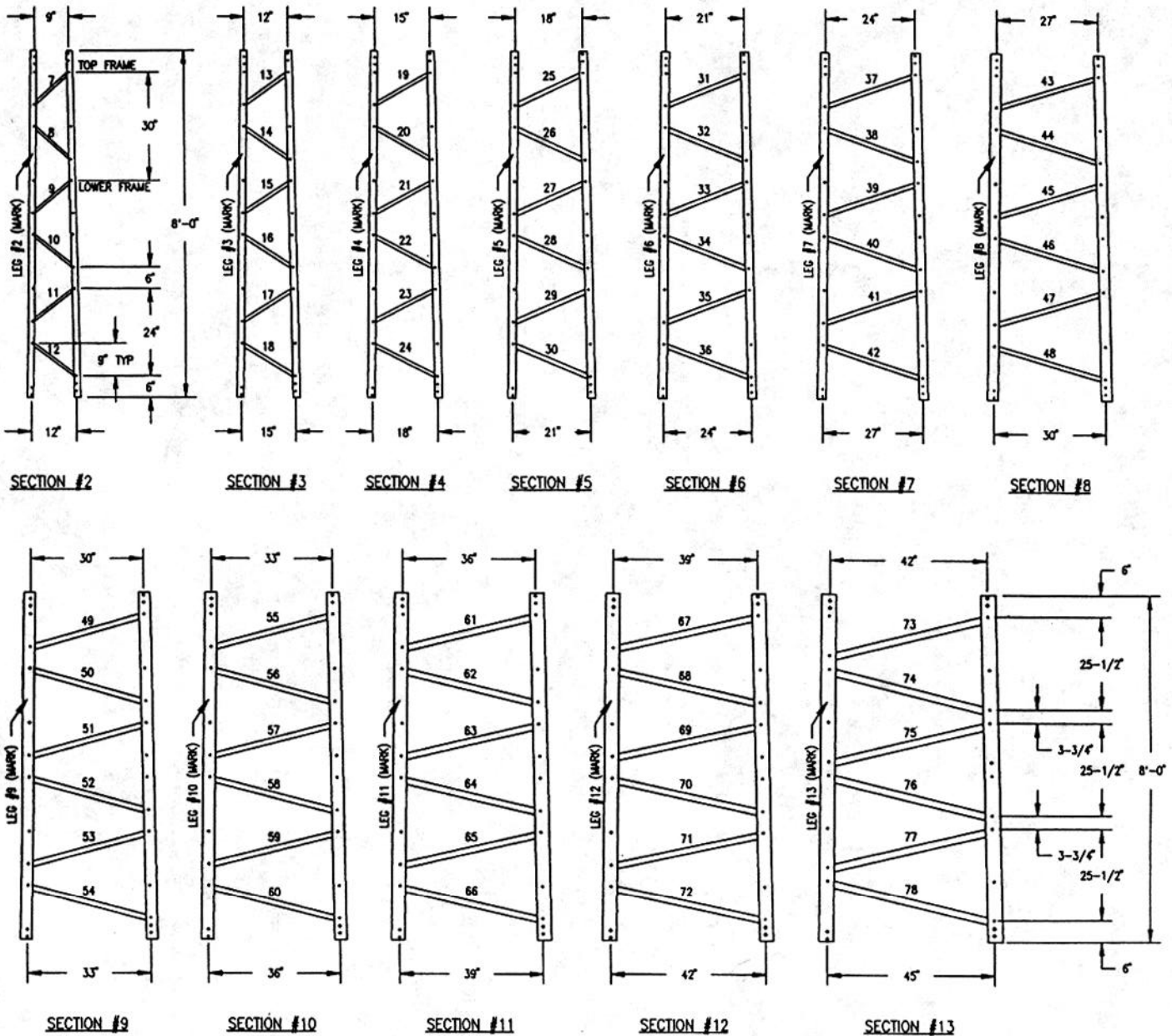

ASSEMBLY NOTES:

- 1) SECTION #2 - #8 ARE ASSEMBLED WITH 1/4" x 1/2" GR.5 BOLTS WITH NUTS INSIDE. LOCKWASHER INTEGRAL WITH NUT.
- 2) SECTION #9 - #12 ARE ASSEMBLED WITH 5/16" x 3/4" GR.5 BOLTS WITH NUTS INSIDE. LOCKWASHER INTEGRAL WITH NUT.
- 3) SECTION #13 IS ASSEMBLED WITH 3/8" x 1" GR.5 BOLTS WITH NUTS AND LOCKWASHERS INSIDE.
- 4) ASSEMBLE ANGLES TO TOP SECTION AS A STANDARD. TOP ANGLES ARE AVAILABLE FOR SECTIONS #2 - #8.
- 5) ASSEMBLE SECTIONS WITHOUT ANY VISIBLE TWIST. KEEP STANDS LEVEL TO EACH OTHER.
- 6) ALL BRACING MEMBERS INSIDE LEGS WITH FLANGE FACING TOP END.
- 7) STACK ODD NUMBERS TOGETHER AND EVEN NUMBERS TOGETHER FOR SHIPPING.
- 8) DECALS TO GO ON BOTTOM SECTION LEGS MID SPAN.
- 9) PANEL HEIGHTS ARE THE SAME FOR ALL SECTIONS EXCEPT SECTION #13.
- 10) TOP END OF LEG IS COLOUR CODED.

